



SA mantra and aura series

user manual english





Welcome

Thank you for choosing SA loudspeakers.

System Audio A/S is want enthral people with the best possible musical reproduction.

A pair of SA loudspeakers will create a feeling of being close to the artists. The SA home theatre will drag the audience deeper into the action.

To achieve the best performance we recommend that you careful read through this guide before setting up your new SA loudspeakers.

More information is available on

www.system-audio.com

! important

check the serial number

The serial number is on a sticker on the underside of the speaker plinth. On the SA mantra 10 / 10AV and SA aura 10 / 10AV it is located on the back of the speaker. You may wish to note the serial number down on your invoice and file it along with your insurance policy. Please contact your dealer if there is no serial number on the speaker.

warranty

System Audio A/S provides a two-year warranty against production defects and a five-year warranty on speaker units and crossover network. The warranty does not cover misuse. Repairs and service are done by the dealer or associated workshop. Any changes made to the construction will annul the warranty.

contents of the package

SA mantra 50 / 70 and SA aura 50 / 70

1 x SA mantra loudspeaker

1 x front grille

4 x rubber feet

4 x 6 mm spikes with locknuts

4 x spike protectors

SA mantra 10 / 10AV and SA aura 10 / 10AV

1 x SA mantra loudspeaker

1 x front grille - stereo or AV

SA aura 1

2 x SA aura 1

2 x front grilles

! important

Spikes and rubber feet are placed in holes in the styrofoam. Make sure you remove them before putting away the packing materials.

If any part is missing please contact your dealer as soon as possible.

running in new loudspeakers

All new high quality loudspeakers need a certain period of running-in time. As SA uses long-stroke bass driver with natural rubber surrounds our loudspeakers needs at least 50 - 100 hours of actual music playing at decent sound level. You will notice a gradual improvement in sound quality.

No particular precautions need to be taken during those hours.

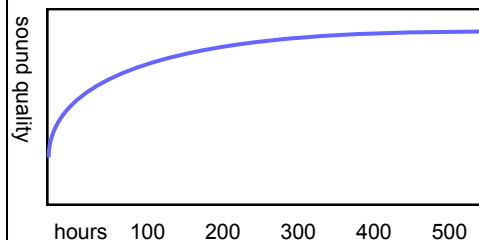

unpacking

- 1 Place the carton bottom-up cut the tape with a knife

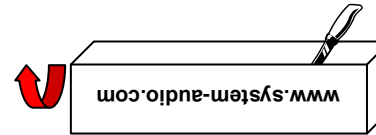

- 2 Turn the carton around and lift off the top

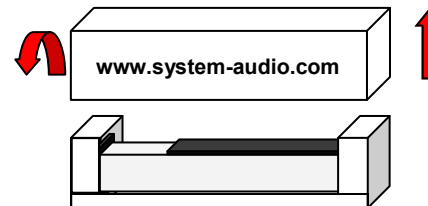

- 3 Lift the loudspeaker out of the bottom part

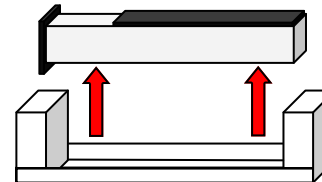

- 4 Remove all accessories from the carton

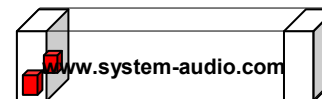

! important

- Always let the product reach room temperature before plugging it in. Condensation may arise in the electronic circuitry when moving the speaker from cold to warm surroundings. Such moisture may damage the speaker's components. Never use the product in damp settings.
- Foreign bodies must not be inserted into the bass reflex ports of the speaker.
- Avoid touching the speaker elements.

set up - floor standing loudspeakers

The SA mantra 50 / 70 and SA aura 50 / 70 are designed to stand on the floor. The speakers can, and should, be placed 30 – 50 cm away from a solid wall. The distance may be increased or decreased depending on the acoustics of the room and what kind of sound you want.

After the 50-hour run-in period and appropriate adjustments, the speakers should be mounted on spikes or rubber feet.

spikes. If the speakers are placed on a soft underlay, e.g. a carpet, we recommend that you use spikes. The spikes supplied have locknuts so the speakers can be adjusted as appropriate. It is important that the speakers are completely vertically upright and do not move from side to side. If necessary, spend plenty of time adjusting spikes and locknuts to make sure the speaker rests evenly on all 4 spikes. Once you have finished adjusting them, tighten the nuts.

rubber feet. If the speaker is positioned on a solid underlay, e.g. a wooden floor, we recommend that you use the rubber feet. They break the link with the floor, which often causes vibrations. You can also use spikes and protect you floor with the provided protectors. Please notice that the speakers are likely to glide on a smooth surface when using the protectors.

To make positioning easier you might want to wait with the mounting of spikes or rubber feet until after the right position for the speakers are found.

set up - compact loudspeakers

The SA mantra 10 / 10AV and SA aura 1, 10 / 10AV are designed to be mounted on floor stands, table stands, wall brackets or ceiling brackets. We recommend using the original SA stands and brackets - se page 4.

SA mantra 10 / 10AV and SA aura 1, 10 / 10AV can also be placed directly on bookshelves. For optimal performance there must be free air passage too the reflex port on the rear. Allow 10 cm. behind the speaker and on one side of the speaker.

example of set up

The sound from speakers depends very much on the room and on the way they are set up. You may wish to ask your dealer for advice on how to get the best sound with SA loudspeakers in your home.

Here is some general advice about experimenting with the set up.

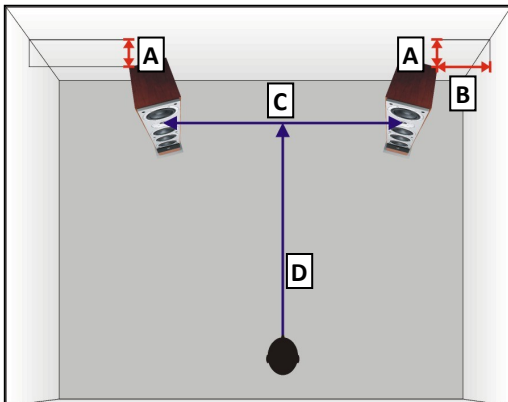

A the distance between the rear of the speakers and the wall behind them

Start with a distance of 30 cm for SA mantra/aura 50 / 70 or 10 cm for SA mantra 10, aura 1 & 10. The distance should be identical for both speakers. Try the speakers out with music you know and find out what distance gives the best sound in your home.

Greater distance = weaker bass, more precise bass, better precision and bigger sound stage.

Shorter distance = more and softer bass, smaller sound stage.

B the distance from the side walls to the speakers.

Preferably greater than the distance to the back wall

A short distance to the side walls increases the amount of bass in the same way as A.

C, D the distance between the speakers and the listener.

The ideal distance between the speakers is 2.5 – 3 metres. Distances C & D should preferably be the same.

The speakers should be at an angle of approx. 15°. This means the listener should just be able to see the two inner sides of the speakers

connection

SA mantra- & aura-series are quality speakers which can be used for any Hi-fi stereo or surround system.

The speakers do not need a particularly strong electrical current from the amplifier, e.g. 2 x 50 W will often run a set of SA mantra- or SA aura-series speaker, with a good result, provided the quality of the amplifier and connected equipment is sufficiently high.

! important.

The amplifier must be turned off before the connection is made

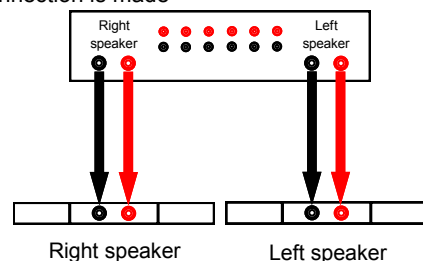

connection – double check

Check that the cables are properly mounted. Make sure the electrical phase is correctly attached to the speaker connections. This means that cables attached to plus (+) or minus (-) on the amplifier/receiver must also be attached to plus (+) or minus (-) on the speakers.

On SA speakers the positive connection is indicated by a red socket or a plus (+).

Follow the speaker cables to make sure that the right and left channels (and the centre and rear channels where appropriate) are attached correctly.

using the sand chamber

SA mantra/aura 50 and 70

When you have found the ideal position for your new speakers, it is a good idea to mark the position precisely so it is easier to find it again. You may want to use strips of tape on the floor.

1. Turn off the amplifier/the receiver and remove the cables from the speakers.

2. Turn the speakers upside-down carefully. Use a soft underlay to avoid scratching the finish. Take care not to touch the drive units!

3. Remove the plastic stopper. You may wish to use a pair of flat-nose pliers to protect your fingers.

4. Fill with dried sand. Use a litre measure, so you can pour the same volume of sand into both speakers.

The SA mantra / aura 70 can hold 3,5 Litres, and the SA mantra 50 / aura 50 can hold 4,4 Litre of sand. We recommend that you use around 2,5 Litre of sand. You might want to experiment to find your own preferred damping level.

! Important

Never use damp sand or the likes. Moisture will seep into the cabinet and damage it.

5. Secure the plastic stopper.

6. Carefully raise the speakers.

7. Place the speakers in the marked positions.

8. Connect the speaker cables

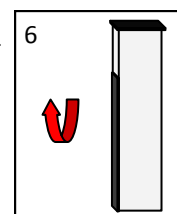
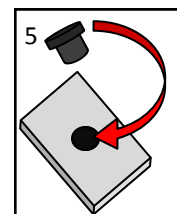
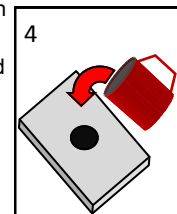
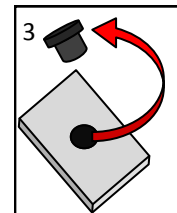
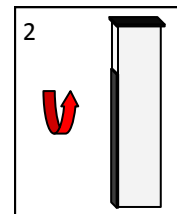

Please notice:

- The better your equipment, the better the speaker will sound
- Good cables improve the sound
- Spend time experimenting with the position of the speakers
- The closer the speaker is to a wall, the more bass. Move them further from the walls for less bass. A corner will significantly increase the amount of bass and make the sound "rumbling" and "massive"
- Avoid the use of iron stands underneath compact loudspeakers. Magnetic interference on the crossover will alter the sound
- Never turn the volume up to a level where the sound is no longer good
- Remove the front grille for the best possible sound
- See www.system-audio.com for good advice and ideas

maintenance

Clean the surface of the speaker with firmly wrung damp clothes

! important

Do not use detergent. It may discolour the finish

The fabric front is easily removed by a slight movement away from the speaker and is best cleaned by a vacuum cleaner with a brush-head attached

! important

Do not use a vacuum cleaner to remove dust from the speaker elements. Brush it away gently with a soft brush.



the speaker stand FS3

For SA mantra 10, SA aura 1 & 10



FS3 speaker stand raises the loudspeaker to a height that produces the best sound quality

the table stand TS1

For SA mantra 10, 10AV, SA aura 1, 10 & 10AV



The TS1 table stand can be adjusted to support any center channel speaker with the right listening angel. A must for low or high placed centre channel speakers



recommended home theatre combination with the SA mantra line

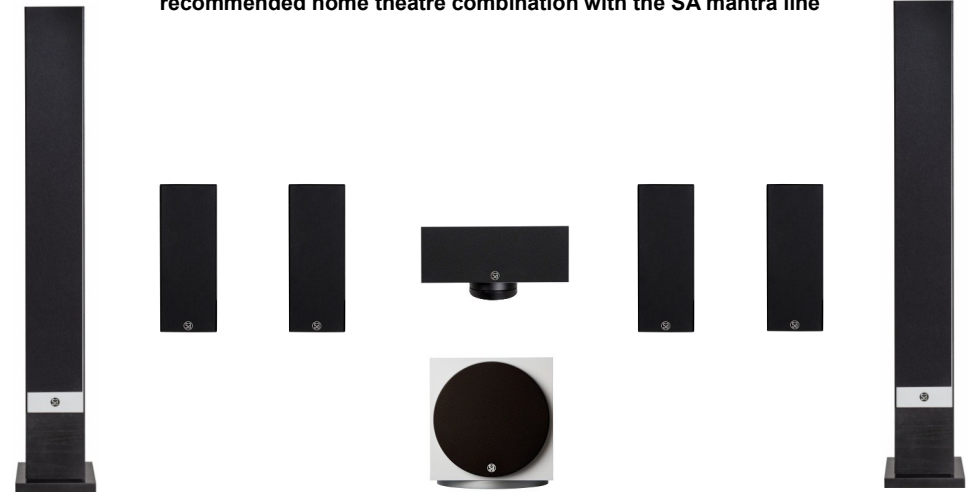

front: SA mantra 70 - surround and back: SA mantra 10 - centre: SA mantra 10AV - subwoofer: SA subElectro 200

wall bracket TLCD1

For SA mantra 10, 10AV, SA aura 1, 10 & 10AV



Wall bracket with tilt or swivel adjustment. Fits VESA 100 standard

wall bracket TLCD2

For SA mantra 10, 10AV, SA aura 1, 10 & 10AV



Wall bracket with tilt and swivel adjustment. Fits VESA 100 standard

Ceiling bracket TLCD3

For SA mantra 10, 10AV, SA aura 1, 10 & 10AV



Ceiling bracket with tilt and swivel adjustment. Fits VESA 100 standard

white front grilles

For all SA mantra- & aura-series



Change from the original black front grille to white. Available for all models

recommended home theatre combination with the SA aura line

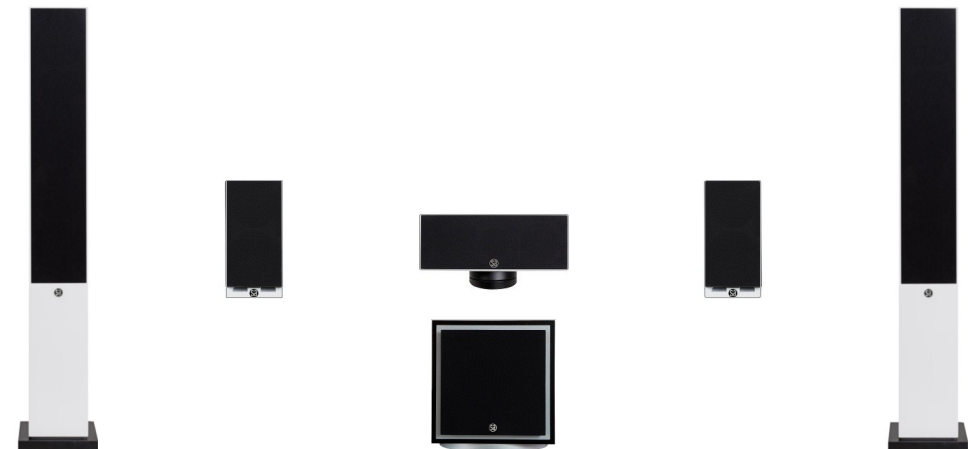

front: SA aura 50 - back: SA aura 1 - centre: SA aura 10AV - subwoofer: SA subElectro 175

follow SA on facebook: www.facebook.com/systemaudio